

- NOTES:
- SIZE 25 PITCH HARMONIC GEAR WITH 101:1 RATIO
 - THE FOLLOWING PARTS (SOLD AS SEPARATE KIT, PART # RGM25-CUST-KIT) ARE REQUIRED FOR CONNECTION TO ANOTHER JOINT OF THE SAME SIZE TO ENSURE IP RATING:
 - (1) PLASTIC SEAL RING
 - (1) RUBBER SEAL BAND
 - (16) M4X0.7 X 10MM LONG SOCKET HEAD CAP SCREWS
 - TORQUE M4 SCREWS IN OUTPUT PLATE TO 4.3Nm [38 IN-LB] AND USE REMOVABLE THREADLOCKER ON SCREWS.
 - CAN CONNECTOR: TE CONNECTIVITY 5-292271-2
 - POWER FERRULES: PHOENIX 3201592
 - SEE RGM USER MANUAL FOR ELECTRICAL CONNECTIONS.

| REVISION HISTORY | | | | |
|------------------|------------|-------------|------|-------|
| REV | ECO NUMBER | DESCRIPTION | DATE | APP'D |
| | | | | |

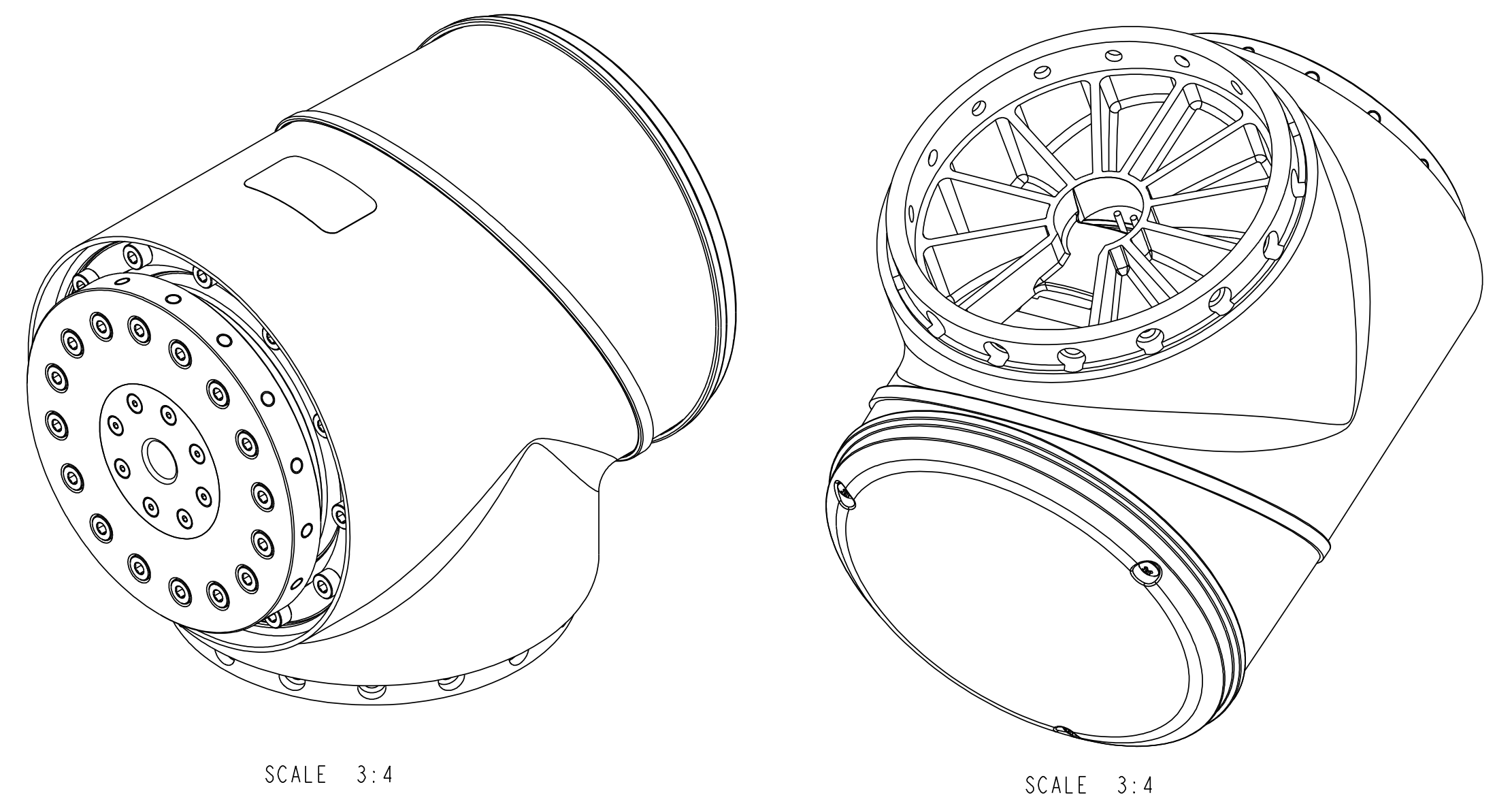
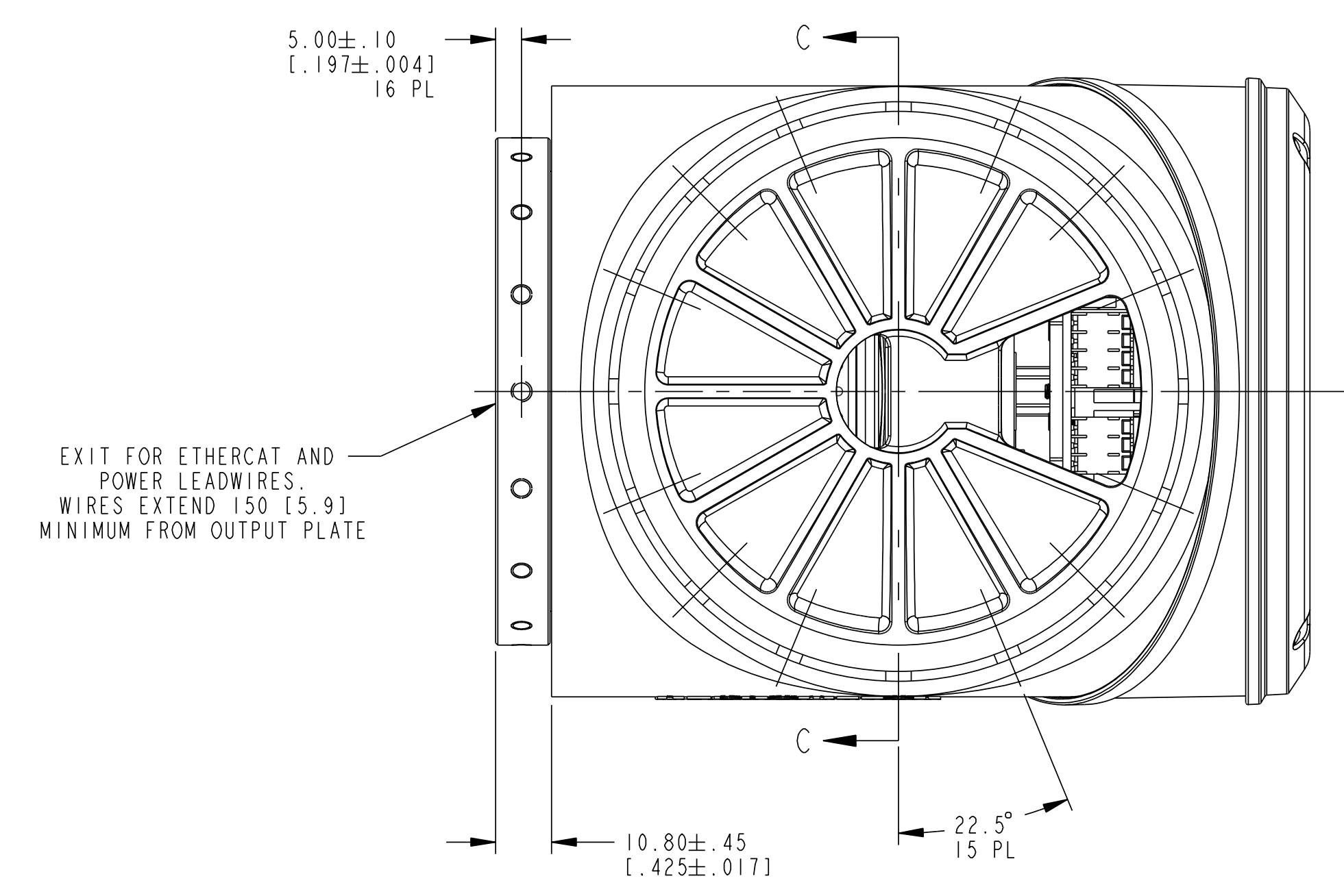
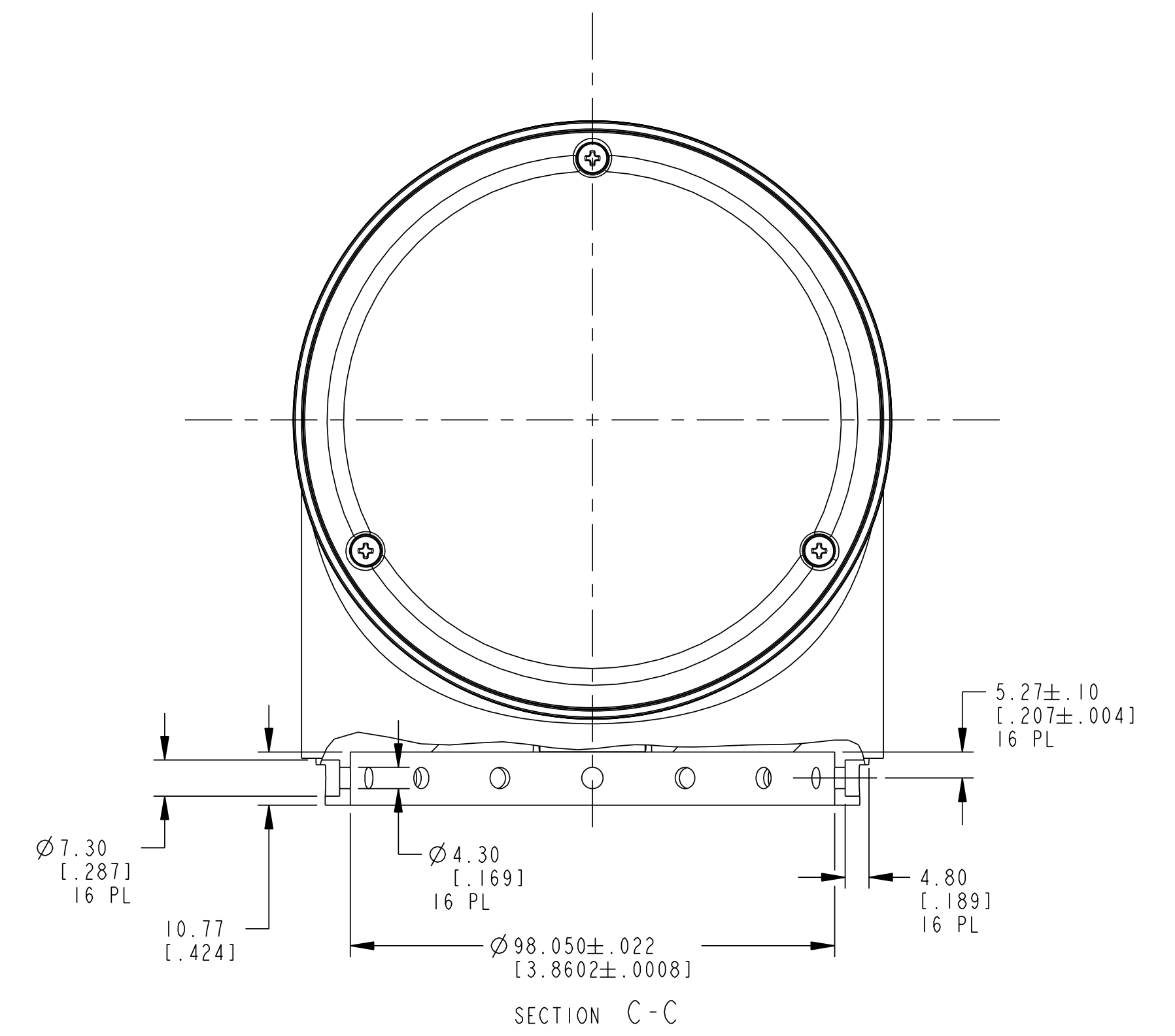
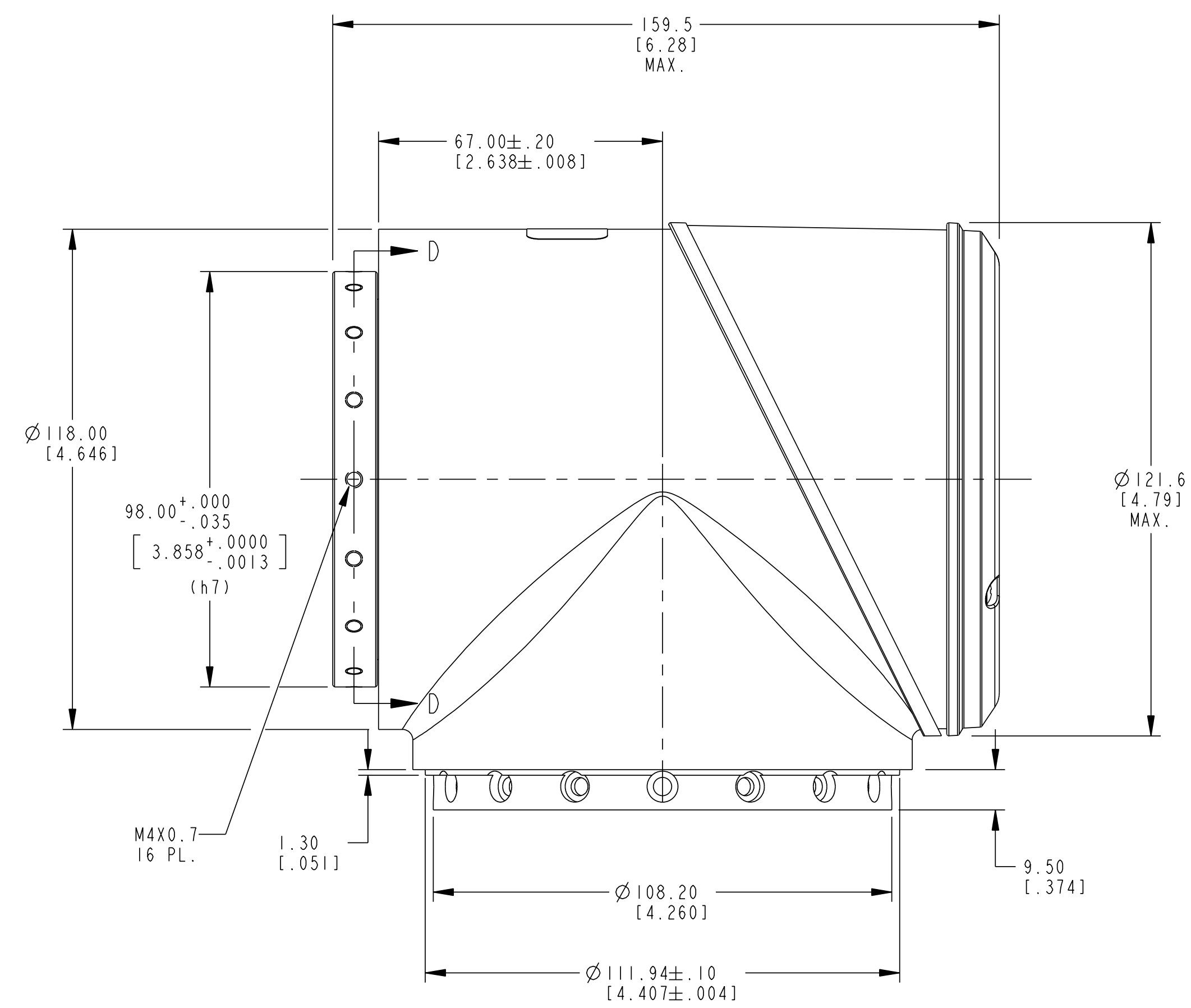
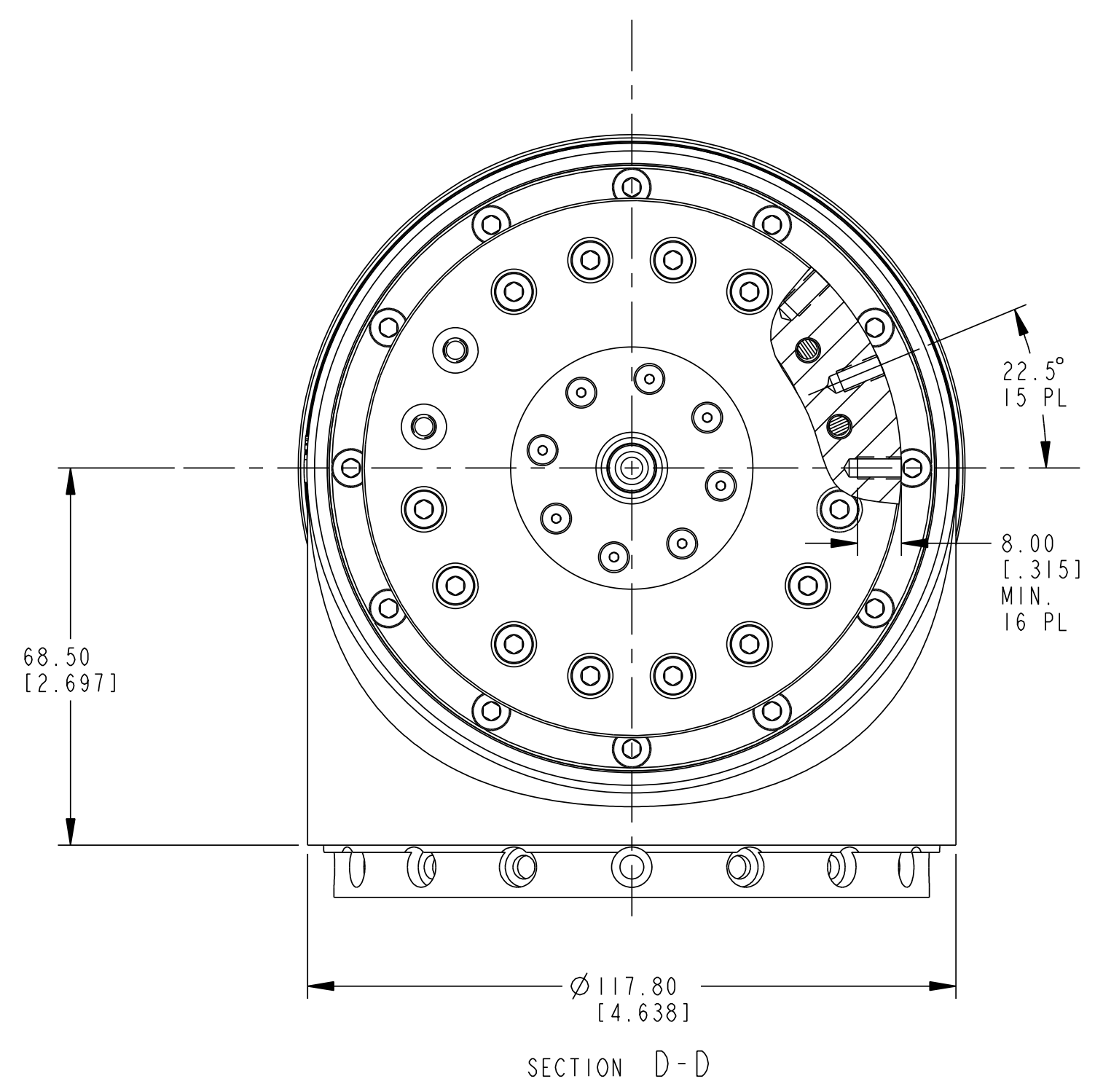

| | |
|---|-----------------|
| This drawing contains PROPRIETARY information and is the property of KOLLMORGEN. This drawing may not be copied or used without prior written approval of KOLLMORGEN. | |
| INTERPRET GEOMETRIC SYMBOLS PER ASME Y14.5M-1994 | |
| Pro/E Model File Rev | PD |
| Pro/E Instance Name | RGM25_MAIN_ECAT |
| Pro/E Drawing Name | 971166 |
| Pro/E Model Type | ASSEM |
| Pro/Engineer Drawing | |

| | | |
|---|--|--|
| SIGNIFICANT PRODUCT CHARACTERISTIC | UNLESS OTHERWISE SPECIFIED: DIMENSIONS APPLY BEFORE COATINGS REMOVE ALL SHARP BURRS AND BREAK ALL SHARP EDGES | KOLLMORGEN Design Control Location: 201 West Rock Road Radford, Virginia 24141 United States of America |
| | MILLIMETER VALUES: ANGULAR TOLERANCE: ±1° X DEC. PLACE: ±.4mm XX DEC. PLACE: ±.13mm | |
| CRITICAL PRODUCT CHARACTERISTIC | INCH VALUES: ANGULAR TOLERANCE: ±1° XX DEC. PLACE: ±.015° XXX DEC. PLACE: ±.005° | OUTLINE RGM25 (ETHERCAT) |
| | DO NOT SCALE DRAWING USE DIMENSIONS ONLY ALL DIMENSIONS ARE MM (INCH) INCH DIMENSIONS IN BRACKETS [] ARE FOR REFERENCE ONLY | |
| THIRD ANGLE PROJECTION | DRAWN BY: JDB-11-13 CHECKED BY: [] APPROVED BY: [] | DATE: [] DATE: [] DATE: [] |
| SIZE: D CAGE CODE: - DWG. NO.: 971166 SCALE: 1:1 | | REV: - SHEET 1 OF 1 |